

PolySwitch® PTC Devices

Overcurrent Protection Device

Raychem Circuit Protection Products

PRODUCT: TS250-130F-B-0.5

DOCUMENT: SCD 26239
PCN: REFER TO TABLE III BELOW
REV LETTER: D
REV DATE: MAY 23, 2007
PAGE NO.: 1 OF 1

Specification Status: RELEASED

Maximum Operating Voltage: 60V_{DC}

Fault Ratings at 20°C:

250 V_{RMS}, 3A, 10 applications
600 V_{RMS}, 1A, 5 applications

Additional Info at 20°C:

Resistance matched: 0.5 ohm
Lightning withstand: 1.5kV per ITU-T
Helps equipment meet ITU-T K.20/K.21 specifications

Terminal Material: Tin-Plated Brass

Marking:

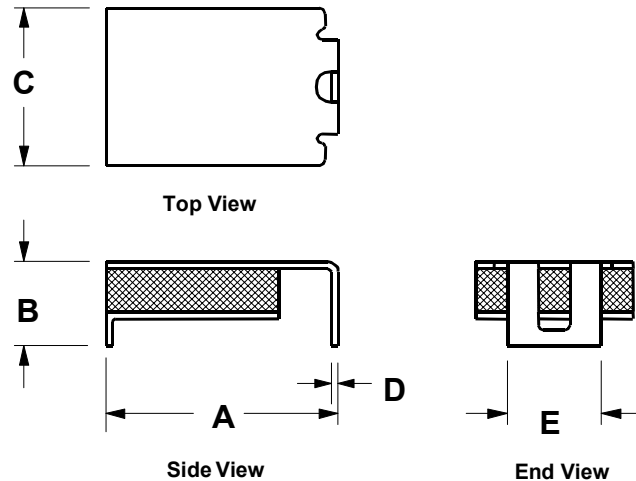
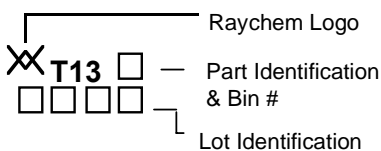

TABLE I. DIMENSIONS:

	A		B		C		D NOM	E NOM
	MIN	MAX	MIN	MAX	MIN	MAX		
mm:	8.5	9.4	--	3.4	--	7.4	0.3	3.8
in:	(0.335)	(0.370)	--	(0.135)	--	(0.290)	(0.011)	(0.150)

*Rounded off approximation

TABLE II. PERFORMANCE RATINGS @ 20°C (unless otherwise noted):

HOLD CURRENT (A)	TRIP CURRENT (A)	RESISTANCE (Ω)			TIME TO TRIP(Sec) @ 1A		OPERATING TEMPERATURE (°C)		TRIPPED POWER DISSIPATION (W) TYP @ 60V _{DC}
		R MIN	R MAX	R _{1 MAX} *	TYP	MAX	MIN	MAX	
0.130	0.260	6.5	12.0	20.0	0.9	2.5	-40	85	1.1

*Maximum device resistance at 20°C measured 1 hour post trip and 24 hours post reflow

TABLE III. APPLICABLE PART DESCRIPTIONS:

PART DESCRIPTION	PCN # (INTERNAL ONLY)	PACKAGING TYPE	NOTE
TS250-130F-B-0.5-2	A13328-000	Tape and Reel	N/A

Agency Recognitions: UL, CSA, TUV
UL File #E74889, CSA File #78165C

Reference Documents: Raychem PS300, ITU-T K.20/K.21

Precedence: This specification takes precedence over documents referenced herein.

Effectivity: Reference documents shall be the issue in effect on the date of invitation for bid.

Caution: Operation beyond the rated voltage or current may result in rupture, electrical arcing or flame.

Materials Information
ROHS Compliant

ELV Compliant

Pb-Free

